

ARCHITECT'S STAMP

CONSULTANT

PROJECT NAME

COUNTY  
 FIRE STATION NO. 17  
 REMODEL

PROJECT ADDRESS

6412 G  
~~6430~~ PONY EXPRESS TRAIL  
 POLLOCK PINES, CA 95726

DRAWING NAME

EXISTING  
 REFLECTED  
 CEILING PLAN

SUBMITTAL

DATE

NO	DATE	REVISION
△		
△		
△		
△		
△		
△		

DRAWN BY: JK

CHECKED BY: JK

DATE: 07/28/2020

SCALE: NOTED

PROJECT NUMBER: 202103

DRAWING NUMBER:

EPO

HVAC SCHEDULE

☒	-SUPPLY AIR	ESTAT	-THERMOSTAT
☒	-RETURN AIR	VTR	-VENT THROUGH ROOF
☒	-EXHAUST FAN		

Electrical Schedule:

☐	-FLORESCENT LIGHTING
⊕	-Lighting fixture.
⊕	-Surface mounted lighting fixture.
⊕	-Recessed lighting fixture
⊕	-Exterior flood lighting/sensor lighting.
⊕	-Fan / light combo
⊕	-Smoke Detector
⊕	-110V duplex receptical
⊕	-110V GFC receptical
⊕	-220V receptical
⊕	-COMMUNICATIONS
⊕	-TELEPHONE
⊕	-LIGHT SWITCH
⊕	O: OCCUPANCY SENSOR
⊕	D: DIMMER
⊕	H: HUMIDISTAT CONTROLLED
⊕	-220V receptical
⊕	-SPEAKER
⊕	-GARBAGE DISPOSAL
⊕	-UNDER CABINET
⊕	-SPEAKER VOLUME

APPROVED  
 Add as E for use on all plans  
 and remove from all plans  
 when not used  
 J. S. M.  
 www.johnkristedja.com  
 916.933.7633

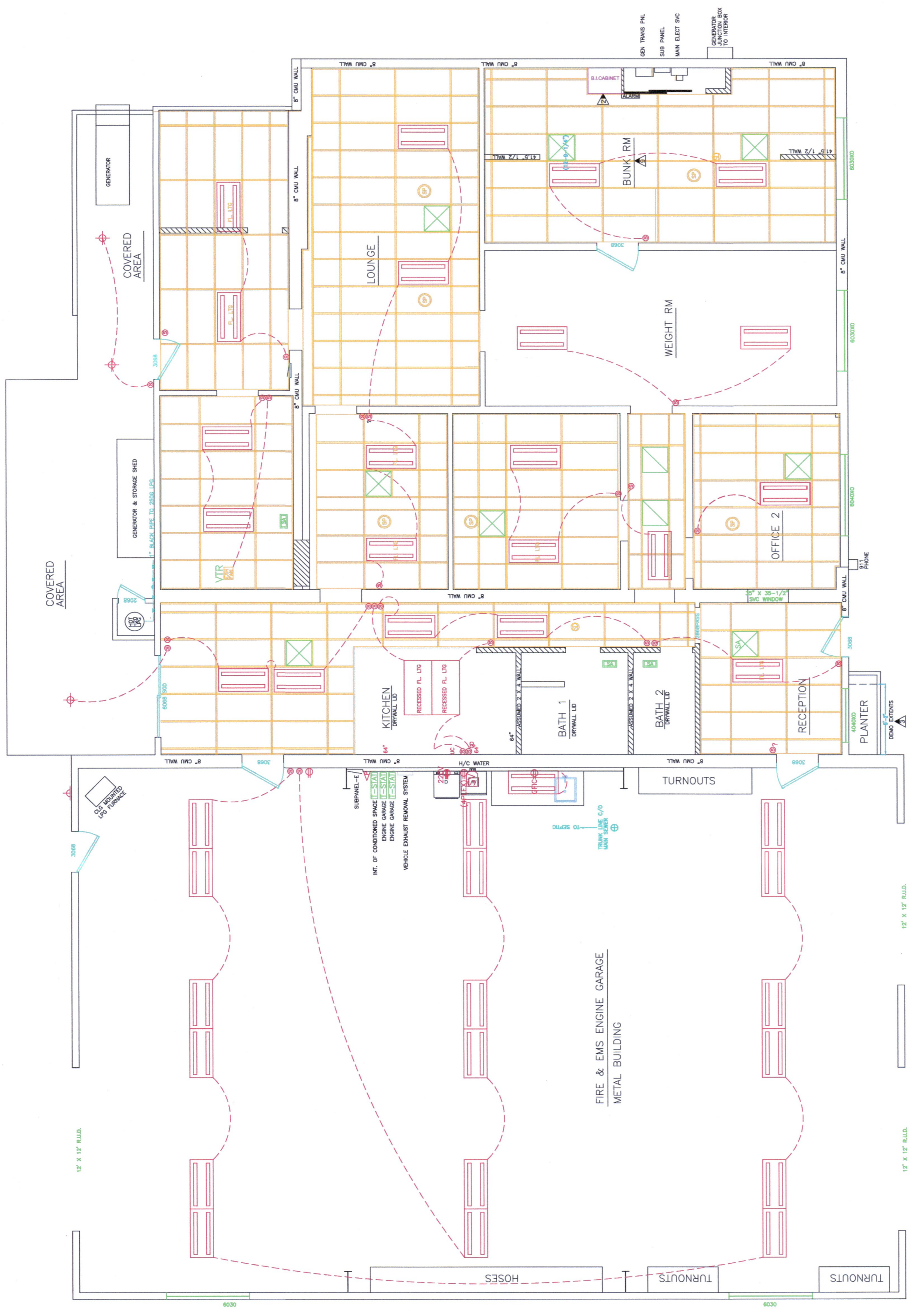

EXISTING REFLECTED CEILING PLAN  
 1/4"